

# KM-1900SRH

## STACKABLE ICE CUBER

Item # \_\_\_\_\_

Project: \_\_\_\_\_

Qty: \_\_\_\_\_

\*AutoCad available on KCL

KM-1900S\_H(3)

2/09

Item # 13234

### CUBER DIMENSIONS

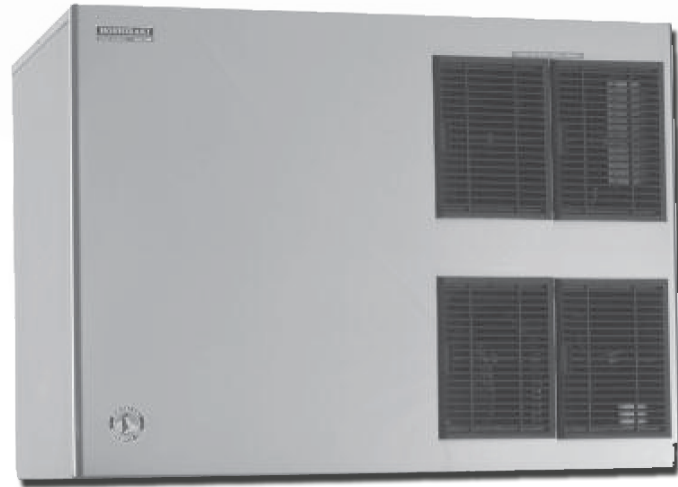

W x D x H

**KM-1900S\_H(3)**  
48 x 27<sup>3/8</sup> x 36<sup>7/16</sup>



### KM-1900SRH

Remote Air-Cooled 1 Phase

- Up to 1965 lbs. of ice production per 24 hours
- Durable stainless steel exterior
- Protected by *HoshiGuard* Antimicrobial Agent 
- CycleSaver® design 
- EverCheck® alert system 
- Individual crescent cube
- Stainless steel evaporator
- Stackable for 3930 lbs. per 24 hour ice production in the same floor space
- Removable air filters (Air-cooled model only)
- R-404A Refrigerant
- Complies with California Energy Commission guidelines (CEC)

\* The KM-1900SRH is ENERGY STAR certified.



### Warranty

Valid in United States, Canada, Puerto Rico, & U.S. Territories. Contact factory for warranty in other countries.

**Three Year** - Parts & Labor on entire machine.

**Five Year** - Parts & Labor on: Evaporator.

**Five Year** - Parts on: Compressor, air-cooled condenser coil.



# KM-1900S\_H(3) STACKABLE ICE CUBER

## DIMENSIONS

W x D x H

**KM-1900S\_H(3)**  
48 x 27<sup>3/8</sup> x 36<sup>7/16</sup>

## STACKABLE ICE CUBER

- Air-cooled 1 phase / Air-cooled 3 phase
- Water-cooled 1 phase / Water-cooled 3 phase
- Remote Air-cooled 1 phase / Remote Air-cooled 3 phase

### AIR - COOLED 1 PHASE / 3 PHASE

Water Temp ° F.	50°	70°	90°
Air Temp ° F.			
70°	1867 / 1859	1777 / 1763	1638 / 1633
80°	1798 / 1786	1659 / 1636	1511 / 1507
90°	1777 / 1763	<b>1560 / 1530</b>	1413 / 1398

### WATER - COOLED 1 PHASE / 3 PHASE

Water Temp ° F.	50°	70°	90°
Air Temp ° F.			
70°	1876 / 1825	1868 / 1822	1734 / 1693
80°	1870 / 1823	1858 / 1818	1655 / 1619
90°	1868 / 1822	<b>1850 / 1814</b>	1673 / 1642

### REMOTE AIR - COOLED 1 PHASE / 3 PHASE

Water Temp ° F.	50°	70°	90°
Air Temp ° F.			
70°	1915 / 1965	1827 / 1876	1676 / 1708
80°	1848 / 1897	1712 / 1758	1543 / 1566
90°	1827 / 1876	<b>1616 / 1660</b>	1451 / 1474

### UTILITY CONSUMPTION

Model Number	Ice Production Per Cycle		KWH per 100 LBS.	Potable Water Gal. per 100 lbs.	Condenser Water Gal. per 100 lbs.
	Lbs.	Cubes			
KM-1900SAH	45.3	2160	4.1	18.8	N/A
KM-1900SAH3	45.5	2160	4.1	17.0	N/A
KM-1900SWH	47.0	2160	3.1	18.8	99
KM-1900SWH3	45.4	2160	3.3	18.8	99
<b>KM-1900SRH</b>	46.3	2160	3.9	20.0	N/A
KM-1900SRH3	46.5	2160	4.1	20.0	N/A

### SPECIFICATIONS

Model Number	Condenser	Amperage	Min. Circuit Ampacity	Shipping Weight
KM-1900SAH	Air-Cooled	14.4	30	415 lbs.
KM-1900SAH3	Air-Cooled	8.6	20	415 lbs.
KM-1900SWH	Water-Cooled	12.5	30	415 lbs.
KM-1900SWH3	Water-Cooled	8.4	20	415 lbs.
<b>KM-1900SRH</b>	Remote Air-Cooled	14.9	30	415 lbs.
KM-1900SRH3	Remote Air-Cooled	11.0	20	415 lbs.

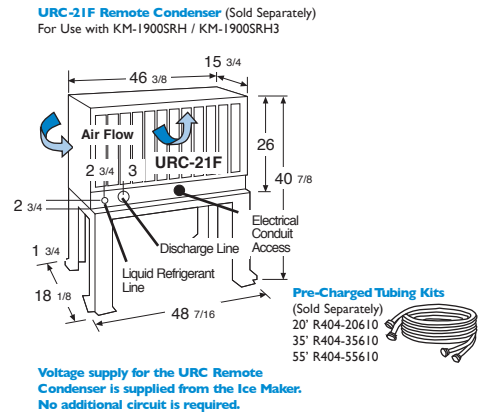
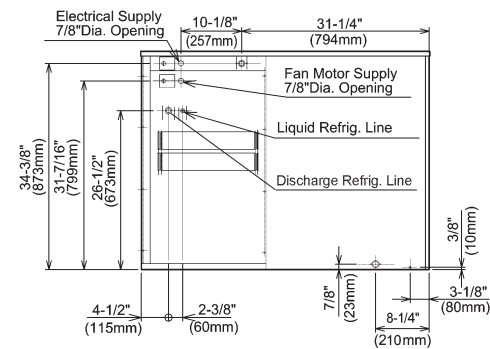
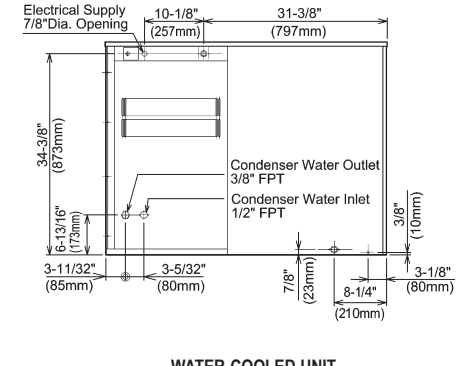
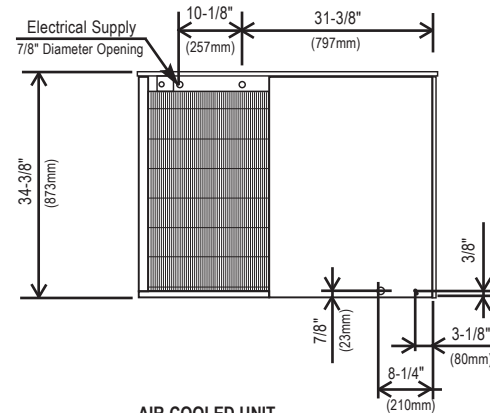
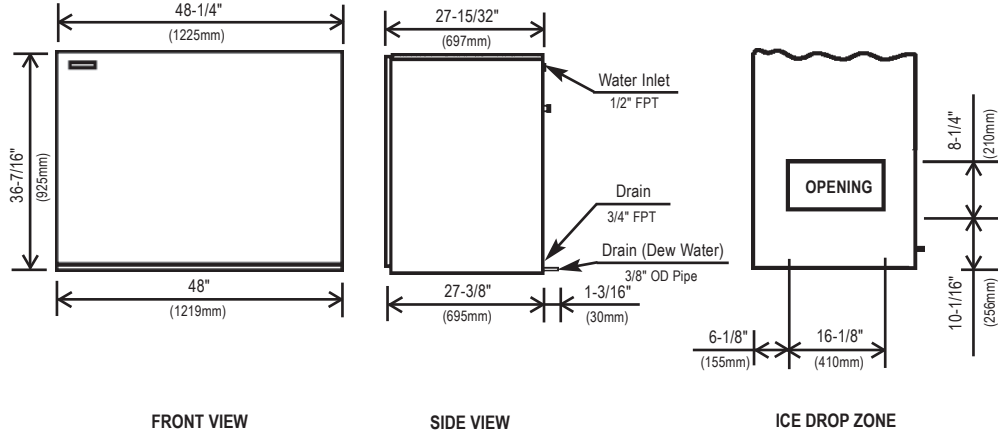

### ELECTRICAL & PLUMBING / KM-1900S\_H(3)

- KM-1900SAH / SVWH / SRH
- 208 - 230V/60/1Ø (3 wire with neutral for 115V)
  - 30 amp Max Fuse/HACR Breaker Size
- KM-1900SAH3 / SVWH3 / SRH3
- 208 - 230V/60/3Ø
  - 20 amp Max Fuse/HACR Breaker Size
  - 1/2" OD copper or equivalent independent potable water supply
  - 3/4" FPT independent drain connection



© HOSHIZAKI AMERICA, INC.

618 Hwy. 74 S., Peachtree City, GA 30269

### OPERATING LIMITS

- Ambient Temp Range 45 - 100°F
- Water Temp Range 45 - 90°F
- Water Pressure 10 - 113psig
- Voltage Range 187 - 253V

### CONDENSING UNIT

- Voltage Range 104 - 127V
- Ambient Temp Range -20 - 122°F

### SERVICE

- Panels easily removed and all components accessible for service.
- Removable/cleanable air filters (Air-cooled model only)

TEL 1-800-438-6087

FAX 1-800-345-1325

www.hoshizaki.com

Printed in U.S.A.

